

Red Diamond “Sigma” Al Shape (Small Crucibles)

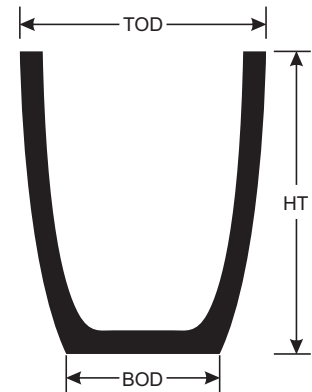

TYPE SIZE	PART DESCRIPTION	HT MM	TOD MM	BOD MM	BRIMFUL CAPACITY WATER LITRES
Al 0.5	A&0074H0080	80	74	50	0.16
Al 1	A&0092H0095	95	92	65	0.28
Al 1.4	A&0094H0110	110	94	54	0.26
Al 2	A&0110H0120	120	110	75	0.55
Al 3	A&0120H0135	135	120	80	0.74
Al 3.1	A&0110H0130	130	110	70	0.53
Al 4	A&0140H0155	155	140	100	1.26
Al 4.1	A&0115H0140	140	115	75	0.66
Al 4.2	A&0115H0141	141	115	75	0.60
Al 5	A&0140H0165	165	140	100	1.37
Al 5.1	A&0125H0150	150	125	85	0.86
Al 5.2	A&0127H0155	155	127	87	0.94
Al 6	A&0140H0172	175	140	100	1.48
Al 6.1	A&0106H0165	165	106	90	0.99
Al 6.2	A&0130H0165	165	130	90	1.16
Al 8	A&0155H0180	180	155	105	1.78
Al 10	A&0175H0200	200	175	120	2.37
Al 10.1	A&0162H0205	205	162	115	1.87
Al 12	A&0175H0210	210	175	120	2.5
Al 14	A&0175H0225	225	175	120	2.8
Al 15	A&0200H0200	200	200	120	3.3
Al 16	A&0200H0230	230	200	120	3.9
Al 16L	A&0215H0235	235	215	130	4.1
Al 18	A&0215H0250	250	215	130	4.4
Al 18L	A&0220H0260	260	220	140	4.9
Al 20	A&0230H0265	265	230	140	5.4
Al 25	A&0230H0280	280	230	140	5.9
Al 30	A&0255H0280	280	255	165	7.5
Al 32	A&0245H0340	340	245	175	7.8

Note

Crucible Working capacity = 90% of (Water liter Capacity x Specific gravity of the metal)

• Specific gravity of various metals are as below:

Brass = 8.35 Gold = 19.3 Zinc = 7.12
Copper = 8.9 Silver = 10.5 Iron = 7.85

All dimensions are subject to normal manufacturing tolerances. Morgan reserves the right to change specifications at any time

Red Diamond “Sigma” AI Shape (Small Crucibles)

TYPE SIZE	PART DESCRIPTION	HT MM	TOD MM	BOD MM	BRIMFUL CAPACITY WATER LITRES
AI 32(S)	A& 0245H0325	325	245	175	7.5
AI 34	A&0245H0360	360	245	175	8.3
AI 35	A&0268H0300	300	268	185	8.6
AI 40	A&0268H0315	315	268	185	9.2
AI 41	A&0268H0330	330	268	185	9.5
AI 42	A&0270H0355	355	270	185	10.5
AI 50	A&0305H0330	330	305	195	10.6
AI 50TW	A&0288H0340	340	288	195	12.1
AI 55	A&0305H0350	350	305	195	11.6
AI 60	A&0307H0375	375	307	195	12.1
AI 70	A&0325H0385	385	325	210	14.5
AI 80	A&0325H0410	410	325	210	15.8

Red Diamond “Sigma” AI Shape (Big Iso-Static Crucibles)

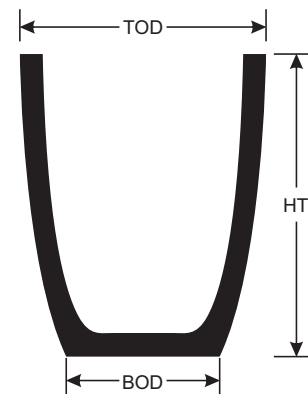

TYPE SIZE	PART DESCRIPTION	HT MM	TOD MM	BOD MM	BRIMFUL CAPACITY WATER LITRES
AI 85	A&0325H0430	430	325	210	16.5
AI 86	A&0330H0410	410	330	227	18.1
AI 90	A&0350H0404	404	350	240	20.6
AI 100	A&0350H0410	410	350	240	21.0
AI 110	A&0350H0420	420	350	240	21.8
AI 120	A&0350H0435	435	350	240	23.0
AL 120 L	A&0350H0450	450	350	245	20.6
AI 125	A&0380H0420	420	380	240	

Note

Crucible Working capacity = 90% of (Water liter Capacity x Specific gravity of the metal)

• Specific gravity of various metals are as below:

Brass = 8.35 Gold = 19.3 Zinc = 7.12
Copper = 8.9 Silver = 10.5 Iron = 7.85

All dimensions are subject to normal manufacturing tolerances. Morgan reserves the right to change specifications at any time

Red Diamond “Sigma” AI Shape (Big Iso-Static Crucibles)

TYPE SIZE	PART DESCRIPTION	HT MM	TOD MM	BOD MM	BRIMFUL CAPACITY WATER LITRES
AI 135	A&0380H0450	450	380	240	25.2
AI 150	A&0380H0475	475	380	240	26.6
AI 151	A&0380H0485	485	380	240	27.2
AI 180	A&0380H0500	500	380	240	28.5
AI 180 L	A&0380H0522	522	380	240	33.9
AI 185	A&0430H0500	500	430	260	33.8
AI 185 L	A&0429H0500	500	429	280	34.4
AI 195	A&0410H0500	500	410	295	35.6
AI 197	A&0410H0527	527	410	295	38.2
AI 200	A&0430H0540	540	430	260	37.6
AI 200 L	A&0435H0540	540	430	280	38.2
AI 225	A&0430H0565	565	430	260	40.0
AI 225 L	A&0435H0565	565	435	280	40.7
AI 250	A&0430H0590	590	430	260	42.4
AI 250 L	A&0435H0590	590	435	280	43.2
AI 255	A&0440H0545	545	440	295	48.4
AI 260	A&0430H0610	610	430	260	44.3
AI 260 L	A&0436H0610	610	436	280	45.2
AI 280	A&0430H0635	635	430	260	47.6
AI 280 L	A&0436H0635	635	436	280	47.0
AI 300	A&0475H0585	585	475	320	55.0
AI 305	A&0440H0540	540	440	315	44.6
AI 307	A&0440H0590	590	440	315	51.0
AI 324	A&0480H0500	500	480	280	45.0
AI 325	A&0475H0600	600	475	320	56.7
AI 326	A&0490H0600	600	490	280	59.2
AI 350	A&0475H0640	640	475	320	61.7
AI 351	A&0490H0640	640	490	280	64.3
AI 351.2	A&0490H0670	670	490	280	68.5
AI 352	A&0490H0710	710	490	280	74.3
AI 355	A&0560H0600	600	560	360	75.8
AI 355L	A&0560H0600	600	560	390	77.0
AI 400	A&0564H0660	660	564	360	86.6
AI 400L	A&0563H0660	660	564	390	84.6
AI 401	A&0540H0660	660	540	315	78.4
AI 400.1	A&0564H0715	690	564	360	92.9
AI 402	A& 0515H0620	620	515	360	72.8

Note

Crucible Working capacity = 90% of (Water liter Capacity x Specific gravity of the metal)

• Specific gravity of various metals are as below:

Brass = 8.35 Gold = 19.3 Zinc = 7.12
Copper = 8.9 Silver = 10.5 Iron = 7.85

All dimensions are subject to normal manufacturing tolerances. Morgan reserves the right to change specifications at any time

Red Diamond “Sigma” AI Shape (Big Iso-Static Crucibles)

TYPE SIZE	PART DESCRIPTION	HT MM	TOD MM	BOD MM	BRIMFUL CAPACITY WATER LITRES
AI 405	A&0540H0680	680	540	315	82.6
AI 405 L	A&0540H0700	700	540	315	87.0
AI 406	A&0515H0680	680	515	360	82.3
AI 450	A&0564H0705	705	564	360	95.4
AI 500	A&0564H0720	720	564	360	97.4
AI 500L	A&0567H0720	720	567	390	94.0
AI 501	A& 0545H0720	720	545	315	89.1
AI 502	A&0515H0660	660	515	360	78.8
AI 510	A&0545H0740	740	545	315	93.8
AI 525	A&0564H0740	740	564	360	101.3
AI 525L	A&0567H0740	740	567	390	96.5
AI 550	A&0564H0760	760	564	360	104.6
AI 550L	A& 0567H0760	760	567	390	99.1
AI 551	A&0545H0760	760	545	315	96.4
AI 552	A&0520H0720	720	520	360	88.1
AI 600	A&0564H0810	810	564	360	113.6
AI 600L	A&0570H0810	810	570	390	110.0
AI 601	A&0548H0810	810	548	315	104.8
AI 602	A&0520H0810	810	520	360	101.6
AI 605	A&0564H0840	840	564	360	120.2
AI 625	A&0580H0730	730	580	350	105.0
AI 2430 S	A&0678H0650	650	678	370	126.6
AI 2450 S	A&0695H0800	800	695	370	170.0
AI 2475 S	A&0700H0850	850	700	370	185.0
AI 2500 S	A&0718H01000	1000	718	370	232.0

Note

Crucible Working capacity = 90% of (Water liter Capacity x Specific gravity of the metal)

• Specific gravity of various metals are as below:

Brass = 8.35 Gold = 19.3 Zinc = 7.12
Copper = 8.9 Silver = 10.5 Iron = 7.85

All dimensions are subject to normal manufacturing tolerances. Morgan reserves the right to change specifications at any time

Red Diamond “Sigma” BUI Shape

TYPE SIZE	PART DESCRIPTION	HT MM	TOD MM	BOD MM	BRIMFUL CAPACITY WATER LITRES
BUI 100	BU0523H0402	402	523	305	44.2
BUI 125	BU0524H0451	451	524	305	52.1
BUI 150	BU0525H0492	492	525	305	58.8
BUI 175	BU0526H0551	551	526	305	69.7
BUI 200	BU0527H0600	600	527	305	76.8
BUI 212	BU0590H0550	550	590	360	92.4
BUI 225	BU0590H0630	630	590	360	109.5
BUI 225L	BU0590H0655	655	590	360	111.8
BUI 250	BU0590H0660	660	590	360	115.9
BUI 250L	BU0590H0685	685	590	360	117.6
BUI 300	BU0590H0700	700	590	360	124.4
BUI 300L	BU0590H0725	725	590	360	125.6
BUI 350	BU0590H0800	800	590	360	145.9
BUI 350L	BU0590H0825	825	590	360	148.1
BUI-500	BU0775H0750	750	775	360	210.0
BUI-550	BU0775H0800	800	775	360	228.0
BUI-600	BU0775H0900	900	775	360	266.6

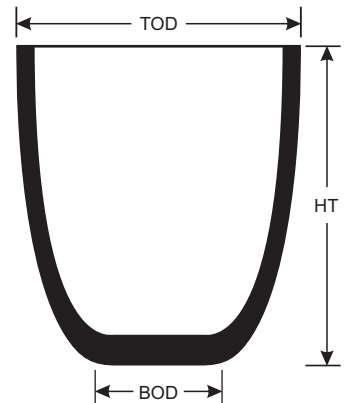

Red Diamond “Sigma” TPI Shape (Without Spout)

TYPE SIZE	PART DESCRIPTION	HT MM	TOD MM	BOD MM	BRIMFUL CAPACITY WATER LITRES
TPI 4	P&0360H0613	613	360	250	32.0
TPI 5	P&0360H0707	707	360	250	38.0
TPI 6	P&0360H0807	807	360	250	44.0
TPI 8	P&0440H0820	820	440	290	72.5
TPI 9	P&0440H0880	880	440	295	79.2
TPI 10	P&0440H0940	940	440	295	85.5
TPI 904	P&0360H0914	914	360	250	50.7
TPI 905	P&0360H0920	920	360	250	51.0

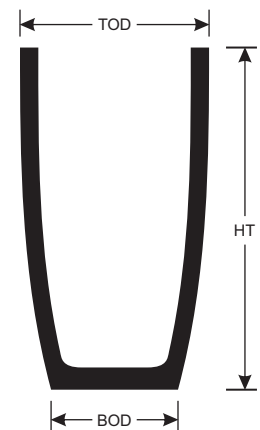

Note

Crucible Working capacity = 90% of (Water liter Capacity x Specific gravity of the metal)

• Specific gravity of various metals are as below:

Brass = 8.35 Gold = 19.3 Zinc = 7.12
 Copper = 8.9 Silver = 10.5 Iron = 7.85

All dimensions are subject to normal manufacturing tolerances. Morgan reserves the right to change specifications at any time

Red Diamond “Sigma” TPI Shape (With Spout)

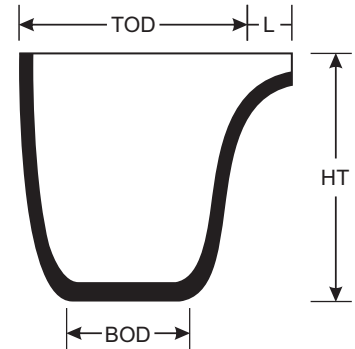

TYPE SIZE	PART DESCRIPTION	HT MM	TOD MM	BOD MM	BRIMFUL CAPACITY WATER LITRES
TPI 150	A&0485H0380 T-LA1300	485	380	240	27.6
TPI 400	P&0360H0613T-LA1300	613	360	250	32.0
TPI 600	P&0360H0807T-LA1300	807	360	250	44.0
TPI 260	A&0380H0485 T-LA1300	485	380	260	44.3
TPI 325	A&0430H0672 T-LA1300	672	430	260	50.3
TPI 326	A&0427H0672 T-SGHT-3GM-LA1D300	672	427	260	43.6
TPI 740	P&0440H0555T-LA1300	555	440	295	49.1
TPI 982	P&0440H0820T-LA1300	820	440	295	72.8
TPI 983	P&0440H0880T-LA1300	880	440	295	79.2
TPI 287	BU0527H0600T-LA1300	600	527	305	76.5
TPI 12	P&0440H0940T-LA1300	940	440	295	85.5
TPI 87	A&0520H0740 T-LA1300	740	520	360	90.5
TPI 88	A&0550H0810 T-LA1300	810	550	315	104.8
TPI 89	A&0564H0810 T-LA1300	810	564	360	113.6
TPI 387	BU0590H0630 T-LA1300	630	590	360	109.5
TPI 387L	BU0590H0655T-LA1300	655	590	360	109.5
TPI 412	BU0590H0800T-LA1300	800	590	360	145.9
TPI 412L	BU0590H0825T-LA1D300	825	590	360	145.9
TPI 525	P&0564H0740T	740	564	360	95.6

Note

Crucible Working capacity = 90% of (Water liter Capacity x Specific gravity of the metal)

• Specific gravity of various metals are as below:

Brass = 8.35 Gold = 19.3 Zinc = 7.12
Copper = 8.9 Silver = 10.5 Iron = 7.85

All dimensions are subject to normal manufacturing tolerances. Morgan reserves the right to change specifications at any time

Red Diamond “Sigma” BNI Shape

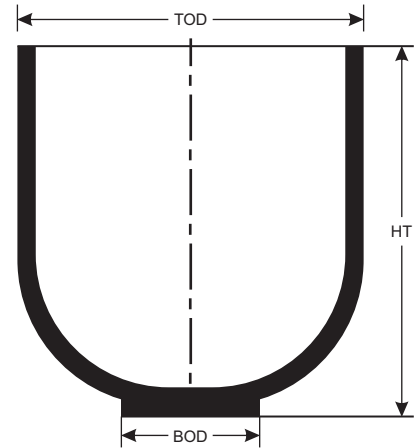

TYPE SIZE	PART DESCRIPTION	HT MM	TOD MM	BOD MM	BRIMFUL CAPACITY WATER LITRES
BNI-202	BNI0617H0500	500	617	260	70.0
BNI-302	BNI0617H0630	630	617	260	97.0
BNI-401	BNI0617H0700	700	617	260	113.0
BNI-402	BNI0617H0800	800	617	260	135.0
BNI-350	BNI0617H0900	900	617	260	140.0
BNI-355	BNI0617H0950	950	617	260	172.0
BNI 500	BNI0785H0750	750	785	310	217.0
BNI 500L	BNI0782H0500	500	782	310	110.2
BNI 550	BNI0785H0825	825	785	310	245.0
BNI 600	BNI0785H0890	890	785	310	270.0
BNI-615	BNI0785H0905	905	785	310	276.0
BNI 700	BNI0785H1000	1000	785	310	312.0
BNI 750	BNI0785H1060	1060	785	310	333.1
TPNI-500	P&0785H0750T	750	785	310	190.0
TPNI-615	P&0785H0905T	905	785	310	253.0
TPNI 700	BU0785H1000T-SGMA-1NN-LA2J146	1000	785	310	296.0
TBNI 600	BU0785H0890T-SGMA-1NN-LA2J146	890	785	310	239.3

Note

Crucible Working capacity = 90% of (Water liter Capacity x Specific gravity of the metal)

• Specific gravity of various metals are as below:

Brass = 8.35 Gold = 19.3 Zinc = 7.12
Copper = 8.9 Silver = 10.5 Iron = 7.85

All dimensions are subject to normal manufacturing tolerances. Morgan reserves the right to change specifications at any time

Red Diamond “Sigma” Cylindrical Crucible For introduction furnace application

TYPE SIZE	PART DESCRIPTION	HT MM	TOD MM	BOD MM	BRIMFUL CAPACITY WATER LITRES
CYI 110X265	CYI0110H0265&	265	110	110	1.5
CYI 222X420 A	CYI0222H0420&	420	222	222	6.8
CYI 222X400	CYI0222H0400&	400	222	222	8.1
CYI 400X700	CYI0400H0700&	700	400	400	61.2
CYI 400X640	CYI0400H0640&	640	400	400	55.6
CYI 400X600	CYI0400H0600&	600	400	400	50.7
CYI 390X632	CYI0390H0632&	632	390	390	49.0
CYI 504X710	CYI0504H0710&	710	504	504	102.5
CYI 504X750	CYI0504H0750&	750	504 <td 504	109.0	
CYI 504X850	CYI0504H0850&	850	504	504	124.4
CYI 550X820	CYI0550H0820&	820	550	550	142.7
CYI 550X850	CYI0550H0850&	850	550	550	122.1

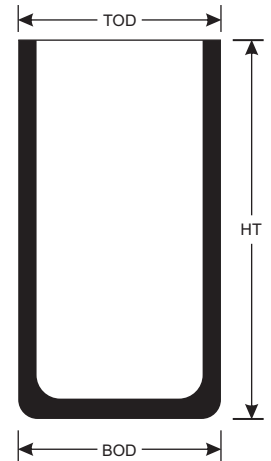

Red Diamond “Sigma” Stand (Cylinder Type)

TYPE SIZE	HT MM	TOD MM	BOD MM
STAND AI/1	125	250	250
STAND AI/2	150	250	250
STAND AI/3	200	250	250
STAND AI/4	250	250	250
STAND AI/5	50	250	250
STAND AI/6	75	250	250
STAND BI/1	125	300	300
STAND BI/2	150	300	300
STAND BI/3	200	300	300
STAND BI/4	250	300	300
STAND BI/5	50	300	300
STAND BI/6	75	300	300
STAND CI/1	125	360	360
STAND CI/2	150	360	360
STAND CI/3	200	360	360
STAND CI/4	250	360	360
STAND CI/5	50	360	360
STAND CI/6	75	360	360

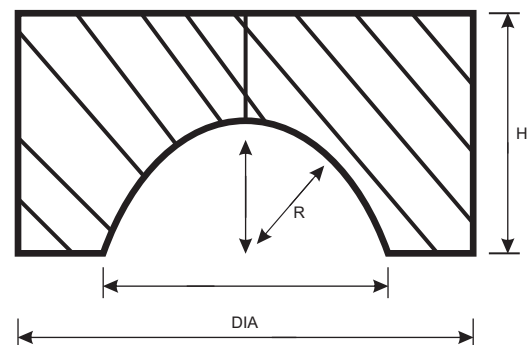

Note

Crucible Working capacity = 90% of (Water liter Capacity x Specific gravity of the metal)

• Specific gravity of various metals are as below:

Brass = 8.35 Gold = 19.3 Zinc = 7.12
Copper = 8.9 Silver = 10.5 Iron = 7.85

All dimensions are subject to normal manufacturing tolerances. Morgan reserves the right to change specifications at any time